

***SIMA CHARTERS b.v.***

**SC Moneypenny**

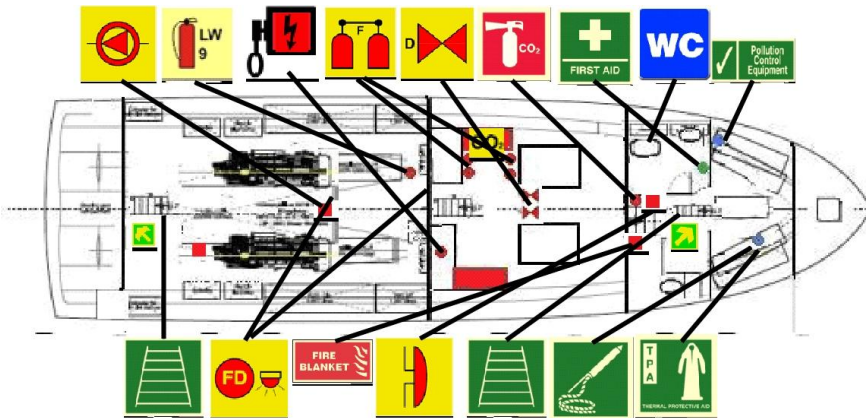

# SC Moneypenny



- No 1 EMERGENCY BILGE PUMP
- No 2 FOAM EXTINGUISHER
- No 3 POWER SWITCH SHUT OFF
- No 4 CO2 CYLINDER BANK
- No 5 DIESEL SHUT OFF VALVES
- No 6 CO2 EXTINGUISHER
- No 7 FIRST AID KIT
- No 8 TOILET
- No 9 OIL SPILL POLLUTION KIT
- No 10 ENGINE ROOM ESCAPE LADDER
- No 11 AUTOMATIC FIRE ALARM SYSTEM
- No 12 FIRE CONTROL PANEL
- No 13 FWD ESCAPE LADDER
- No 14 LINE THROWING EQUIPMENT
- No 15 THERMAL PROTECTIVE AIDS

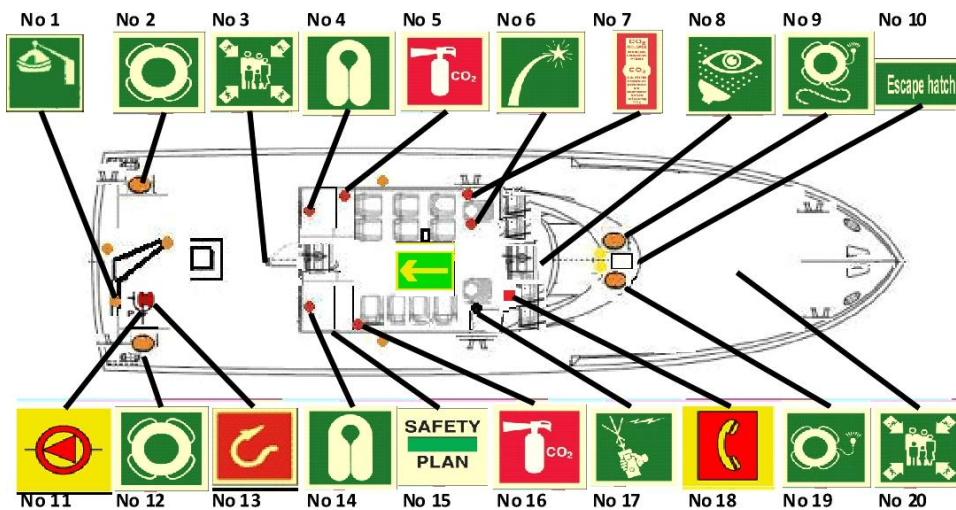

- No 1 MAN OVERBOARD HOIST
- No 2 LIFE BUOY
- No 3 MUSTER STATION
- No 4 LIFEJACKETS
- No 5 CO2 EXTINGUISHER
- No 6 PYROTECHNICS
- No 7 CO2 CONTROL POINT
- No 8 EYEWASH STATION
- No 9 LIFE BUOY WITH LIGHT & LINE
- No 10 ESCAPE HATCH
- No 11 MAIN BILGE PUMP
- No 12 LIFE BUOY
- No 13 EMERGENCY FIRE HOSE
- No 14 LIFEJACKETS
- No 15 SAFETY PLAN
- No 16 CO2 EXTINGUISHER
- No 17 HAND HELD RADIO
- No 18 SHIPS RADIOS & DSC
- No 19 LIFE BUOY WITH LIGHT
- No 20 MUSTER STATION

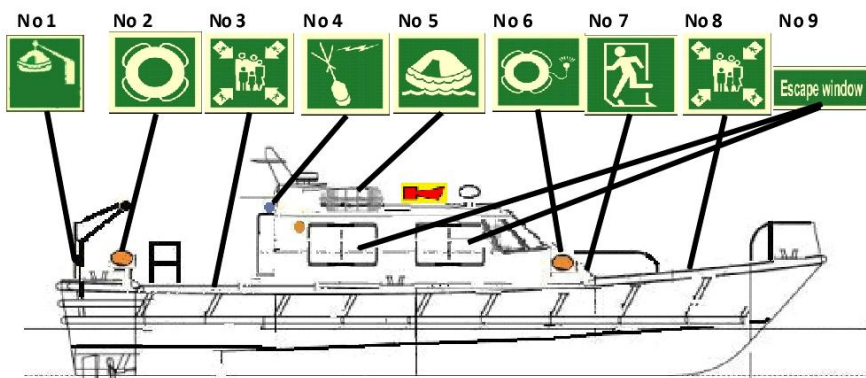

- No 1 MAN OVERBOARD HOIST
- No 2 X2 LIFE BUOYS
- No 3 MUSTER STATION
- No 4 E.P.I.R.B.
- No 5 LIFERAFT
- No 6 X2 LIFE BUOY & LIGHT
- No 7 ESCAPE
- No 8 MUSTER STATION
- No 9 ESCAPE WINDOWS



# SIMA CHARTERS b.v.

Het Ambacht 19 - 3155AK Maasland - Netherlands Phone:+31 10 4346387 Mobile:+31 6 53576201  
Fax:+31 10 2341424

Vat:NL808641724B01 CoC nr:24304536 at The Hague E-mail:info@simacharters.com  
Payment details: Rabobank: 33.62.79.574 Swift Code: RABONL2U Iban code: NL53RABO0336279574  
Web: www.simacharters.com

## SC Moneypenny

### Specifications

#### Classification / Flag

Flag: UK  
Trading area: Coastal waters up to 60 miles  
Call Sign / Imo:MWEP5

Classification society: MCA  
Class ship type : Launch.

#### Principal dimensions

LOA: 13.9 meter (46ft)  
BOA: 4,3 meter (14ft)  
Draft: 1,5 meter  
GRT: 20,27  
NRT: 20,27  
Material : GRP

#### Machinery / Propulsion

Propulsion: 2 x Sabre Man 320HP  
Propulsion type: Twin Fixed Props via Shafts v-drive

Speed: 19 knots

#### Tank Capacities

Fuel: 1900 liter  
Fresh Water: 400 liter

#### Accommodation

In wheelhouse 10 passengerseats and 2 seats for crew.  
Toilet, kitchen, 2 bunks in forecastle

#### Heating

Eperspecher

### Electronics

1	Radar Ratheon R41 rasterscan	1	AIS transponder class A new 2009
1	VHF DSC Skanti	1	computer shuttle with software maxsea(new 2009) and 15 " monitor Nottrot 2009
1	VHF Sailor 2048		
1	portable VHF Entel GMDSS (new 2009)	1	depthsounder
1	GPS compass ?	1	color plotter Standard Horizon
1	Magnetic compass Sestrel (comp 2009)		
1	Epirp ACR (new 2009)		
1	GPS MLR		

### Safety:

According to class, engineroom CO2  
Liferaft zodiac DOT 16 to EPS extreme (new 2009)  
15 new SOLAS inflatable lifejackets  
Medical according to class (new 2009)  
Hadrian rail system around wheelhouse

New batterycharger Phoenix (2010)  
New inverter 3KW multuplus (2010)  
4 new batteries Northstar 170ft (2010)

Certificates from MCA are fresh and valid.